

Self-Cleaning Filters

MODEL DELTA-STRAIN 240-S/L

For Hydrous, Viscose and Super-Viscose Media

The DELTA-STRAIN is a logic, cost-efficient and environmental-protecting way of filtration. DELTA-STRAIN is the trade name of DELTAFILTER Filtrationssysteme GmbH.

- No cartridge filters waste
- Self-cleaning without interruption of process
- In- and outlet at the same height
- Robust and user-friendly filter housing in two parts with DELTA-spindle-quick-action-cover-closure for one hand operation – no tool is required to open and close the housing!
- Low operating costs due to a long service life
- No special spare part stockholding is necessary
- No dismounting of pipelines and gear motor by maintenance and inspection required
- Filtration rates nominal 25 µm – 3000 µm

OPTIONS

⊕-protection ATEX-conformable acc. directive 2014/34/EU, perforated elements for gel-like particles, fibres, algae etc., special voltage, special seals, automatic drain-system, sluices, heating jacket, control of the differential pressure, wall holder, TÜV acceptance etc.

Some branches of industry for example:

Automobile industry
Chemical industry
Electronics industry
Dye, paint and lacquer industry
Semiconductor industry
Cosmetic industry
Plastics industry
Beverages and food industry
Metalworking and steel industry
Mineral oil industry
Paper industry
Pharma industry
Water supply and wastewater treatment companies etc.



DELTA-STRAIN 240-S/L,
1.4571, 10 bar

Please take care of the product description and the technical dimensions on the back ▶

Product Description

The filter housing, constructed in two parts, has a sump with DELTA-spindle-quick-action-cover-closure for one hand operation. The sump can be dismantled downwards. The filtersystem of DELTAFILTER Filtrationssysteme GmbH is extremely robust and is designed for extreme applications. If required, the filter element can be dismantled completely without special tools. Seals are not needed for the filter element. The dirt is removed of the filter element by flexible scraper-blades of stainless steel and sinks downwards in the mud reservoir of the sump. The dirt can be discharged by a manual ball-valve or optional by an automatic cut off device, which can be controlled by the time or by the differential pressure. Liquid losses are limited. Sluices can be delivered optionally for the concentration of the dirt.

Technical data

Design and calculations: PED 2014/68/EU, AD2000
 Material of housing: 1.4571 (316Ti) ^{1,2}
 Material of filter element: 1.4435 (316L),
 1.4404 (316L),
 1.4571 (316Ti)

Material of other internal parts: 1.4571 (316Ti), 1.4310

Max. allowable pressure: 10 bar ¹

Max. allowable temperature: 80°C ¹

Housing seal: O-ring FPM ¹

Filter rates nominal: 25 µm – 3000 µm ³

Weight (empty): ca. 37 kg

Drive: gear motor

Motor data: 400 V, 50 Hz, 180 W ¹

Motor protection: IP65 ¹

Flow capacity:

(foin relation to clean water)

50 - 100 µm	150µm
24 m³/h	26 m³/h

Connections

S1 Inlet BSP 2" inner thread ⁴
 S2 Outlet BSP 2" inner thread ⁴
 S3 Discharge BSP 1" outer thread ⁴
 S4 Differential pressure (+) BSP ¼" inner thread
 S5 Differential pressure (-) BSP ¼" inner thread

DELTA-STRAIN 240-S/L

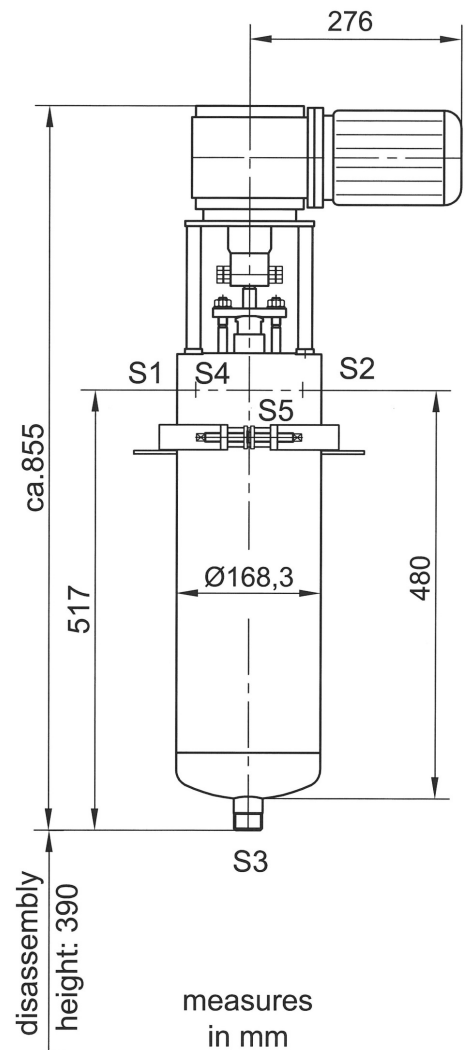

¹ Optional other materials, pressures, temperatures, voltages, protection ratings etc.

² Surface pickled and passivated

³ Optional perforated elements (gel-like particles, fibres, algae etc.)

⁴ Optional with flange connections or welding male part according to German DIN 11851

Illustration, weights and measures are only indices.

We manufacture self-cleaning filters in special construction and alternative material. Our self-cleaning filters of range DELTA-STRAIN are available for flow capacities up to 250 m³/h as standard versions. Higher flow capacities on request.

We will prepare a detailed quotation for you. Test filters are available.

07/16 - Technical changes reserved!